



VENUS D BUILDING

Geroskipou Paphos

Cyprus



VENUS D BLOCK

Yeroskipou
Cyprus

Apartment Block

2 x 2 Bedroom Apartments and 8 x 1 Bedroom Apartments.



The Property WITH TITLE DEEDS

This development is located in a popular residential area of Geroskipou, ideally suited for permanent and holiday home investors. Close to all amenities such as banks, supermarkets, shops and pharmacies and it is a stones throw from Kato Paphos beaches, the harbour with its array of restaurants and the Archaeological Park these spacious executive apartments are located within a short walk to the village centre. The apartment has a stylish Italian kitchen, open plan living area which leads out to an exceptionally large front and secluded side patio areas, a bright double bedroom and a luxury bathroom. Additionally, the apartments have wheelchair access, underground parking which is accessible via an internal lift, and an entry phone system.



Sought after residential location



VENUS D BLOCK

Yeroskipou
Cyprus

Apartment Block
2 x 2 Bedroom Apartments and 8 x 1 Bedroom Apartments.
Excellent rental potential



Specifications

2 x 2 Bedroom Apartments

Covered Areas - From 72 Square Meters to 92 Square Meters

Covered Verandas for 2 of the Apartments - From 13 Square Meters to 33 Square Meters

Uncovered Verandas-Patios for 2 of the Apartments - 25 Square Meters

8 x 1 Bedroom Apartments

Covered Areas - From 47 Square Meters to 59 Square Meters

Covered Verandas for 7 of the Apartments - From 5 Square Meters to 13 Square Meters

Uncovered Verandas-Patios for 3 of the Apartments - 35.8 Square Meters to 76.4 Sqm

All with Private Covered Parking

7 Apartments with Private storage area

Elevator to all levels

Key ready



Workmanship Guarantee Direct From Developer



VENUS D BLOCK

Yeroskipou
Cyprus

Apartment Block

2 x 2 Bedroom Apartments and 8 x 1 Bedroom Apartments.
No VAT is applicable to this property – Saving 19%.



The Area

Geroskipou boasts an abundance of modern day facilities and yet has lost none of its charm as a traditional Cypriot village. Its proximity to Paphos town and International Airport ensures that Geroskipou village is popular choice with locals and visitors alike. Geroskipou is famous for its rare 5 domed Church, traditional pottery and "Cyprus delights". Geroskipou's long, sandy beach has been awarded the accolade of 'blue flag' status and offers bathers a choice of cafes, bars and recreational facilities.

Nestled in the South-West corner in probably the most beautiful part of the island and sheltered from the North by the Troodos mountains, Paphos, once the Roman capital of the island, enjoys mild winters and warm, seemingly endless summers. The irrigation system has helped to turn Paphos into the "garden of Cyprus" and it is also renowned as having one of the healthiest climates in the Mediterranean. Paphos has become the focus of one of the most exciting areas for real estate investment in the eastern Mediterranean. The Government and private enterprise continue to invest heavily in the infrastructure, providing such features as extending the motorway network, extensive improvements to the quaint harbour of Paphos and coastal walkway, a new state-of-the-art marina is planned for around 1000 yachts and upgrading the International Airport into one of the most modern in the Mediterranean basin.



Large Kitchens



VENUS D BLOCK

Yeroskipou
Cyprus

Apartment Block
2 x 2 Bedroom Apartments and 8 x 1 Bedroom Apartments.
Executive apartments



Guarantees

Guaranteed title deeds

12 month workmanship guarantee

10 year structural guarantee

Tailored payment terms

After sales service



Large Varanda



PROJECT:		VENUS D	
TITLE:		GROUND FLOOR	
SIZE:	FSCM NO.:	PLOT:	REV:
SCALE:	DATE:	SHEET:	



PROJECT:		VENUS D	
TITLE:		FIRST FLOOR	
SIZE:	FSCM NO.:	PLOT:	REV:
SCALE:	DATE:	SHEET:	



PROJECT:		VENUS D	
TITLE:		SECOND FLOOR	
SIZE	FSCM NO.	PLOT:	REV
SCALE:	DATE:	SHEET:	

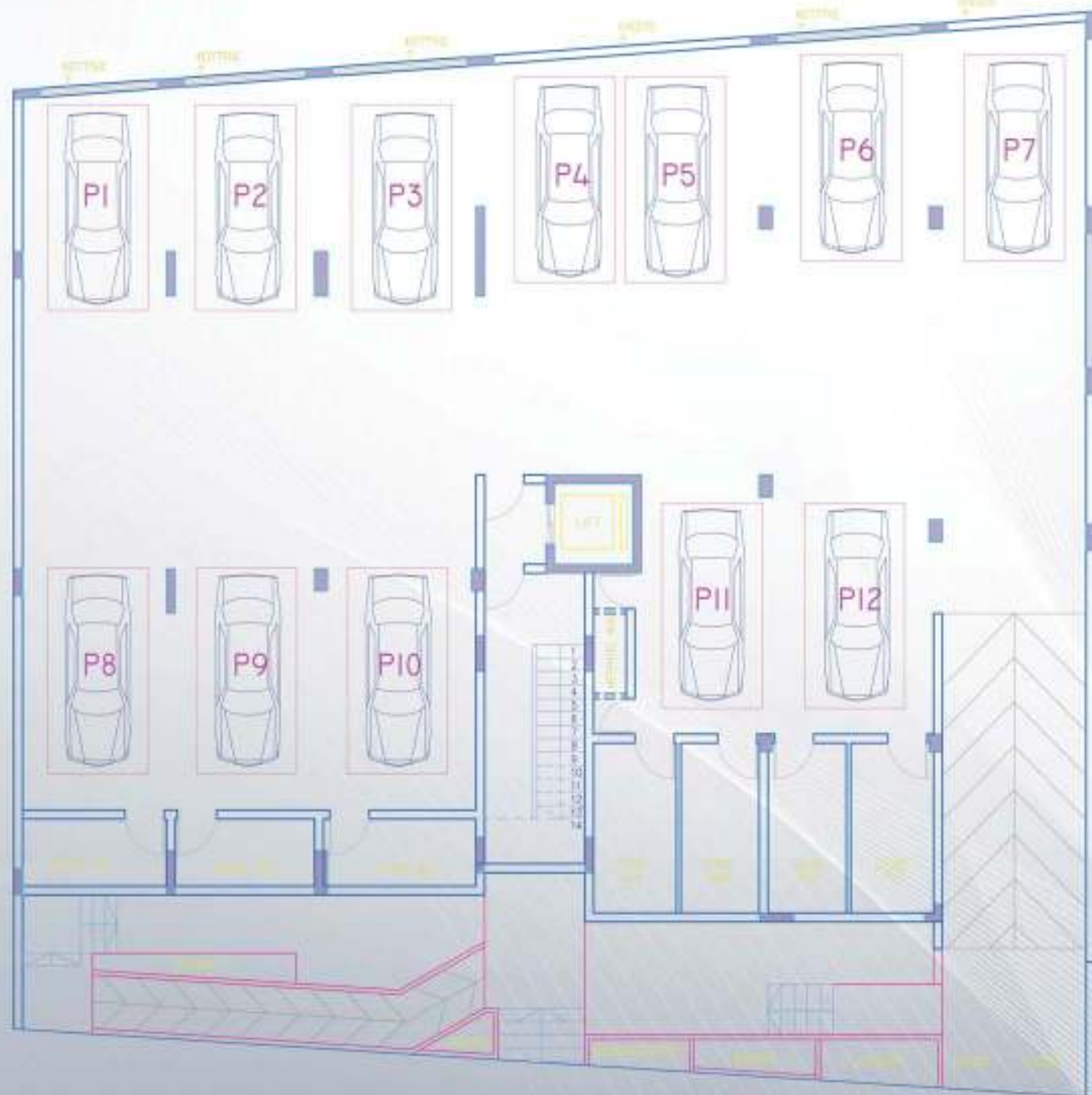

NOTES

PROJECT:		VENTS D	
TITLE:		Basement	
SIZE:	ESOM NO.:	PLOT:	REV:
SCALE:	DATE:	SHEET:	2/3



Maispa Developers
www.maispa.com
maispa@cy.net
00357 26822221